

# Studio S Pro OTG Quick Start Guide

## Introduction

Thank you for choosing Studio S Pro OTG audio interface. Studio S Pro OTG is a 2 in 2 out USB audio interface, with built-in OTG port and 3.5mm phone jack, providing you with a faster and more convenient live streaming experience. Two high quality microphone preamp and 24bit/192kHz high resolution sampling rate, support low-latency ASIO driver on Windows OS and will work straight away without needing to install any drivers on macOS. Please read this manual before you start using, to help you quickly understand the basic operations and features of Studio S Pro OTG.

## Features

- 2 In / 2 Out USB audio interface with 24 bit/192 kHz audio resolution
- 1 XLR input with 48V phantom power supply and Input Gain control
- 1 Line/Hi-Z/MIC TRS input and Input Gain control
- 2 colors Input Level LED
- Independent monitor output volume and headphone volume control
- 2 Level Meters
- Zero latency Stereo/Mono Direct monitor
- Connect to your mobile phone through OTG or 3.5mm jack
- OTG input/output
- High Speed USB 2.0 and bus powered

## Hardware Features

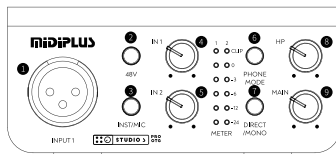

1. INPUT1: Connect microphone via XLR
2. 48V phantom power switch: Turn on 48V phantom power supply of input 1 channel
3. INST/MIC input switch button: Switch instrument/microphone/line input of 6.35mm input. Line in when the button light is off; instrument in when the button blue light is on; microphone in when the button green light is on
4. GAIN 1 control: Adjust the gain level of input1. Rotate counterclockwise to reduce the gain level and clockwise to increase the gain level
5. GAIN 2 control: Adjust the gain level of input2. Rotate counterclockwise to reduce the gain level and clockwise to increase the gain level
6. OTG switch: The button lights Yellow means both the OTG Input and Output are turned on
  - ① Press the switch, the button lights Red means turn on the route from mobile phone to OTG, press the switch twice to turn off the route
  - ② Long press the switch over 2 seconds, the button lights Green means turn on the route from OTG to mobile phone, long press the switch again to turn off the route
7. Direct monitoring mode Switch: Stereo direct monitoring when the button lights blue, and Mono direct monitoring when the button lights green, when the button lights off means Direct monitoring is turned off
8. Headphone output level control: Adjust the headphone output level, rotate counterclockwise to reduce the level, and rotate clockwise to increase the level, and the knob light is the USB status LED
9. Main output level control: Adjust the monitor outputs level. Rotate counterclockwise to reduce the level and clockwise to increase the level



10. Headphone output: 6.35mm stereo output, connect to your headphone
11. Main output: Connect to your monitor
12. INPUT2: 6.35mm mono input, connect to your line in/ instrument/microphone
13. 3.5mm Phone jack: Connect to your mobile phone via the 3.5 TRRS cable
14. Type-C OTG port: Connect to your mobile phone via the Type-C cable
15. USB port: Connect to your computer

# Start Using

## 1. Connect

Connect the Studio S Pro OTG to computer by using the included USB A to USB C cable, the USB status LED on Headphone knob will light on.

## 2. Installation

Windows: Go to <http://midiplus.com/cn/support.aspx?id=1> download and install the latest driver.

macOS: No need to install any drivers.

## 3. Setting the default sound device

Windows: Go to Settings > System > Sound and then selecting the Studio S Pro OTG as your device for Input and Output.

macOS: Go to System Preferences > Sound and then selecting the Studio S Pro OTG as your device for Input and Output.

# Connection Example

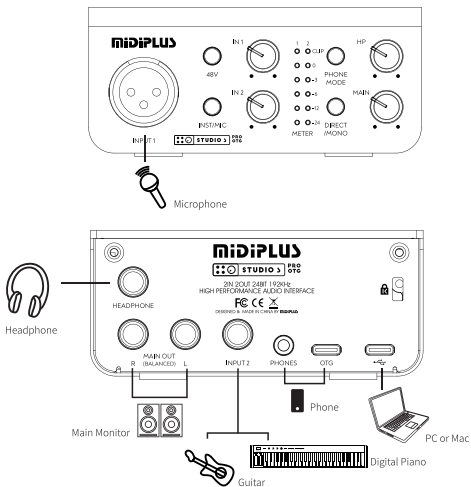

## Specifications:

Model	Studio S Pro OTG
Bit depth/Sample rate	24 bit/192 kHz
I/O	1x XLR Input 1 x 1/4" Headphone Output 2 x 1/4" Monitor Outputs 1x 1/4" Input 1 x 1/8" Phone jack 1 x OTG port 1 x USB port
Buttons	1 x 48V Switch 1 x Hi-Z/mic Switch 1 x OTG Switch 1 x Direct Monitor mode Switch
Knobs	2 x Input Gain control 1 x Monitor level control 1 x Headphone Volume control
Dimensions	116mm*105mm*46mm
Accessories	1 x USB Cable, 1 x Quick Start Guide 1 x 1/4" to 1/8" adapter 1 x Information paper 1 x 1/8" to 1/8" TRRS cable

# Studio S Pro OTG

## 快速入门指南

### 简介

感谢您选择Studio S Pro OTG。这是一款二进二出的音频接口，带有手机OTG接口及3.5mm手机接口，为您提供更快捷方便的直播体验。具备二路高品质话放与24bit/192kHz高精度采样，支持Windows低延迟ASIO驱动及Mac下免驱使用。在开始使用之前请阅读此手册，以帮助您快速了解Studio S Pro OTG的基本功能。

### 产品特性

- 24bit/192kHz高精度的二进二出的音频接口
- XLR输入接口，带48V幻象电源和独立增益调节旋钮
- TRS输入接口，带独立增益调节旋钮，高阻抗模式可接吉他贝斯等乐器，麦克风模式可接动圈麦
- 输入增益旋钮带双色电平指示灯，方便观察输入电平
- 可独立调节耳机音量和主输出监听音量
- 两路LED电平表，实时显示输出电平
- 零延时立体声/单声道直接监听
- 支持手机OTG及3.5mm接口连接
- 可独立控制OTG输入/输出信号开关
- 高速USB2.0(支持3.0)接口

### 硬件功能

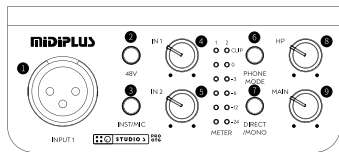

1. 麦克风接口:用于通过XLR连接麦克风

2. 幻象电源开关：开启 INPUT1 的 48V 幻象电源供电
3. 使用模式切换开关：用于切换 INPUT2 的乐器 / 麦克风 / 线路输入模式，按钮灯亮蓝色时表示乐器输入模式，按钮灯亮绿色时表示麦克风输入模式，熄灭为线路输入模式
4. 输入增益旋钮 1：用于调节 INPUT1 的增益量，逆时针旋转减小增益量，顺时针旋转增加增益量，旋钮灯为输入电平指示灯，过载时亮红色
5. 输入增益旋钮 2：用于调节 INPUT2 的增益量，逆时针旋转减小增益量，顺时针旋转增加增益量，旋钮灯为输入电平指示灯，过载时亮红色
6. Phone Mode 开关：按钮亮黄色表示手机 OTG 和声卡互通信号，按钮灯熄灭表示手机和声卡互不传输

①短按开关：按压开关小于两秒时，按钮红灯亮表示开启手机 OTG 信号传输至声卡，红灯灭则关闭

②长按开关：按压开关大于等于两秒时，按钮绿灯亮表示开启声卡音频信号传输至手机 OTG，绿灯熄灭则关闭

7. 直接监听模式按钮：用于控制输入通道的直接监听模式，按钮灯亮蓝色时表示立体声监听模式，按钮灯亮绿色时表示单声道监听模式，熄灭为关闭直接监听

8. 耳机音量旋钮：用于调节耳机输出的音量，逆时针旋转减小音量，顺时针旋转增加音量，旋钮灯为 USB 识别指示灯，连接电脑且被正确识别时亮灯

9. 主音量旋钮：用于调节主输出的音量，逆时针旋转减小音量，顺时针旋转增加音量



10. 耳机接口：6.35mm 立体声耳机输出接口
11. 主输出接口：6.35mm 输出接口，用于连接主监听音箱
12. 输入 2 接口：6.35mm 输入接口，可连接线路 / 乐器 / 麦克风输入
13. 3.5 mm 手机连接口：使用 3.5mm 双头 TRRS 线连接手机
14. Type-C 手机 OTG 连接口：使用 Type-C 线连接手机
15. USB 接口：用于连接电脑

## 开始使用

1. 连接:使用自带的USB连接线将Studio S Pro OTG接到电脑并被正确识别后,耳机旋钮灯将会亮起

2. 安装驱动

Windows用户:访问<http://midiplus.com/cn/support.aspx?id=1> 下载并安装最新的驱动

MacOS:无需安装驱动

3. 设置默认声音设备

Windows用户:转到设置-系统-声音,然后选择Studio S Pro OTG 为输入/输出设备

MacOS用户:转到系统偏好设置-声音,然后选择Studio S Pro OTG 为输入/输出设备

## 连接示例

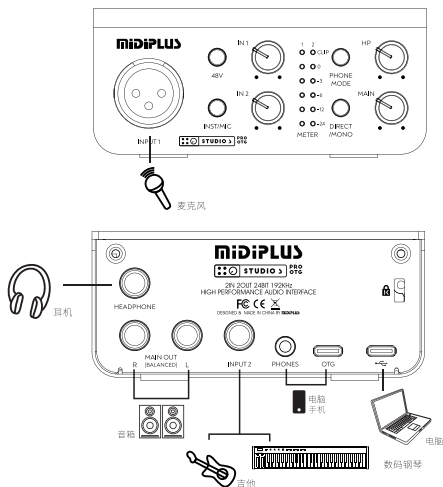

## 产品规格

型号	Studio S Pro OTG
位深度/采样率	24bit/192kHz
I/O接口	1个 XLR接口 1个6.35mm监听耳机接口 2个6.35mm监听音箱接口 1个6.35mm输入接口 1个3.5mm手机OTG接口 1个Type-C手机OTG接口 1个Type-C电脑接口
按键	1个48V幻象电源开关 1个输入模式切换开关 1个手机OTG功能开关 1个立体声/单声道监听切换开关
旋钮	2个输入增益旋钮 1个监听耳机音量旋钮 1个主输出音量旋钮
尺寸	116mm*105mm*46mm
附件	USB线、快速入门手册、音频转接头、 信息卡、双头3.5mmTRRS线